

liteflip[®] autopilot

optrel[®]
swiss made 

Look into the future.



Automatically better welding

The first flip-up with autopilot arrived.

UNTIL TODAY:

THE SEMI-AUTOMATED WELDING MASK...

automatically darkens as soon as the welding arc ignites. The shade level must be set manually according to changing lighting.

NEW:

THE FULLY AUTOMATED WELDING MASK...

automatically darkens as soon as the welding arc ignites. No manual shade level setting necessary. The optrel **liteflip** autopilot automatically adjusts to changing lighting.

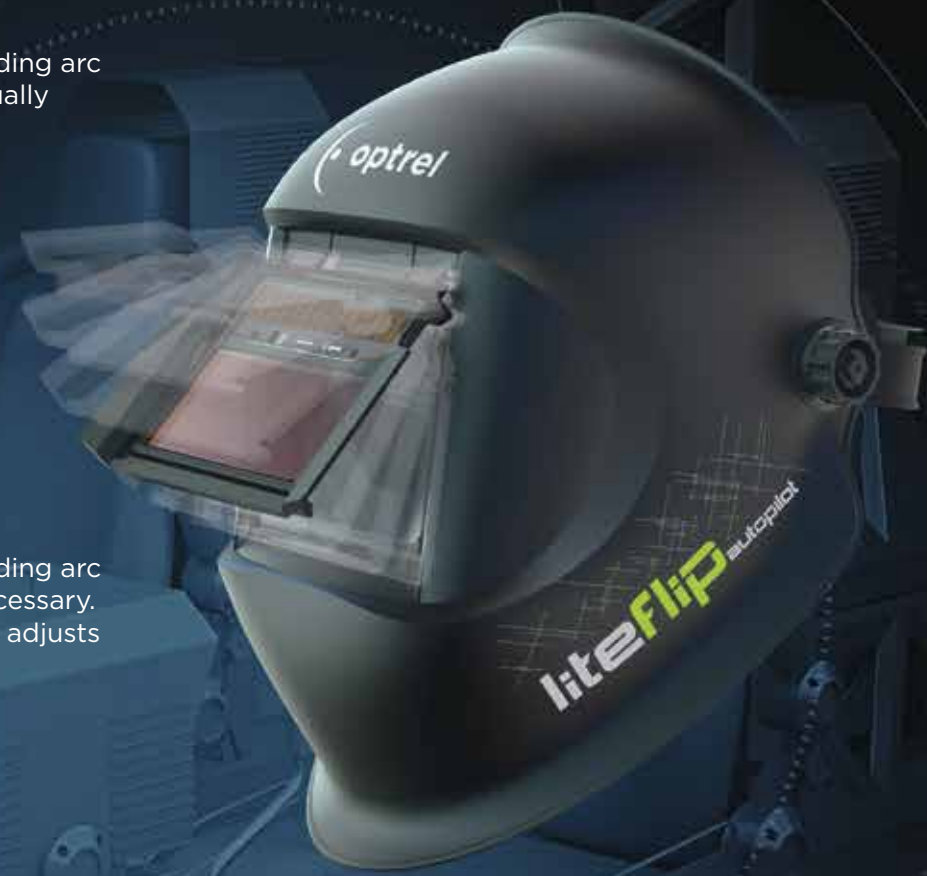

Flip-up open

Clear view

Light state

Inactive mode

Autopilot Range

for all important work sequences

Adjusts automatically to the changing light conditions of the current welding method.

World exclusive: automatical adjustment up to shade level 14!

shade level

1

4

5

6

7

8

9

10

11

12

13

14

BONUS

optrel **liteflip** autopilot:

Combines the advantages of a flip-up welding helmet with the comfort of the optrel autopilot. Combines perfectly with the optrel e3000 respiratory protection.

Welding made easy.

Super lightweight flip-up welding helmet with automatic shade level adjustment makes welding much more comfortable and easy.



AUTOPILOT WITH SHADE LEVELS 1 / 4 / 5-14

With a shade level range from 5 to 14 and fully automatic adjustment, the optrel **liteflip autopilot** achieves a new level of performance: All work sequences, such as measuring, testing, grinding, and other welding applications, can be handled without any manual adjustments at the helmet. And of course, without displacing the helmet itself. The welder is always protected perfectly.



TRUE-COLOR VIEW

The specially developed UV/IR filter allows a realistic perception of colours and at long last brings colour into the world of the welder.



TWILIGHT ADF TECHNOLOGY

Unlike other ADF lenses that rapidly return to light, the Twilight ADF Technology restores light more naturally, presenting a smoother transition to the eyes. This exclusive technology reduces eye fatigue on welders who are continuously welding, enabling them to work safer and more comfortably.



LIGHTWEIGHT

Weighing only 530g, the **liteflip autopilot** is one of the lightest flip-up welding helmets available. Its ergonomic design minimizes strain on the head and neck, ensuring comfort throughout the work day.

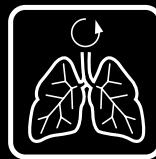

RESPIRATORY PROTECTION

The **liteflip autopilot** is perfectly combined with the optrel e3000 PAPR respiratory system. With its integrated high-performance particle filter (TH3), welders are adequately protected against smoke, dust, and aerosols.



2+1 YEAR WARRANTY

Register your optrel **liteflip autopilot** online and receive an additional year of warranty for free.





TECHNICAL DATA

Description	<p>Fully automatic welding helmet (no manual adjustment necessary) with flip-up function for a clear view.</p> <p>True-color view, ADF with shade level range 3/5-14 with autopilot (automatic shade level adjustment), +/- 2 individual manual offset, sensitivity adjustment, and opening delay with or without twilight function.</p>	Classification	<p>Optical class: 1</p> <p>Scattered light: 1</p> <p>Homogeneity: 1</p> <p>Angular dependence: 2</p>
Shade levels	<p>Open / clear view: shade level 1</p> <p>Closed / inactive: shade level 4</p> <p>Closed / active: shade levels 5-14</p>	Shape stability	<p>Welding mask: up to 220°C / 428°F</p> <p>Front cover lens: up to 137°C / 279°F</p>
Autopilot	Automatic shade level adjustment for shade level range 5 to 14 with individual calibration option of ± 2.	Eye protection	Ultraviolet / Infrared Protection: maximum protection at any shade level
Power supply	Photovoltaic cell, 2 pcs batteries 3V exchangeable (CR2032)	Operating temperature	-10°C to +70°C / 14°F to 158°F
Operating time batteries	Approx. 3,000 hours (operating)	Storage temperature	-20°C to +80°C / -4°F to 176°F
Sensors	3 sensors	Weight	<p>Standard helmet: 530 g / 18.7 oz</p> <p>PAPR helmet: 730 g / 25.8 oz</p>
Sensitivity	Infinite adjustment, new with "Super High" range	Application ranges	<p>Any electric arc welding process</p> <p>Electrode Welding (Stick Welding, SMAW) / MIG / MAG (GMAW) / GMAW</p> <p>High melting rate process / Flux Cored Wire Welding / TIG welding (GTAW) / Plasma Arc Welding / Plasmacutting & Oxy-gas Welding</p> <p><i>Prohibited for laser welding!</i></p>
Switching time	<p>Light to dark:</p> <p>0.100 ms at room temperature</p> <p>0.100 ms at 55°C / 131°F</p> <p>Dark to light:</p> <p>0.3 s or 1.5 s (with twilight function)</p>	Scope of delivery	Welding helmet, instruction manual, storage bag, batteries, warranty card
Field of view	<p>Flip-up open: 82 x 102 mm</p> <p>Flip-up closed: 50 x 100 mm</p>	Standards	CE, ANSI Z87.1, EAC, complies with CSA Z94.3
		Warranty	<p>2 years (except batteries)</p> <p>1 year warranty extension for online product registration within the first 6 month.</p> <p>http://register.optrel.com</p>

Helmet system

Art. Nr.

Main accessories

Art. Nr.



liteflip autopilot welding helmet 1006.700



optrel parking buddy 5002.900



liteflip autopilot welding helmet with industrial helmet 1006.750



Front cover lens 5000.391



liteflip autopilot fresh air helmet 4441.700



Safety lens 5000.390



liteflip autopilot fresh air helmet with industrial helmet 4441.750



optrel bag for helmets 9410.043.00



Spare parts and accessories

Art. Nr.

1	Helmet shell liteflip autopilot	5001.916
	PAPR helmet shell liteflip autopilot	4290.000
2	Safety lens (5 pcs.)	5000.390
3	Inside cover lens (5 pcs.)	5000.001
4	Spare ADF cartridge	5012.490
5	Front cover lens (5 pcs.)	5000.391
6	Cotton sweatband (2 pcs.)	5004.073
7	Adjustable headband (including sweatband and comfortband)	5003.250
8	Cotton sweatband (2 pcs.)	5004.020
9a	Head & neck protector, leather	4028.016
9b	Head & neck protector PAPR, leather	4028.031
10	Chest protector, leather	4028.015

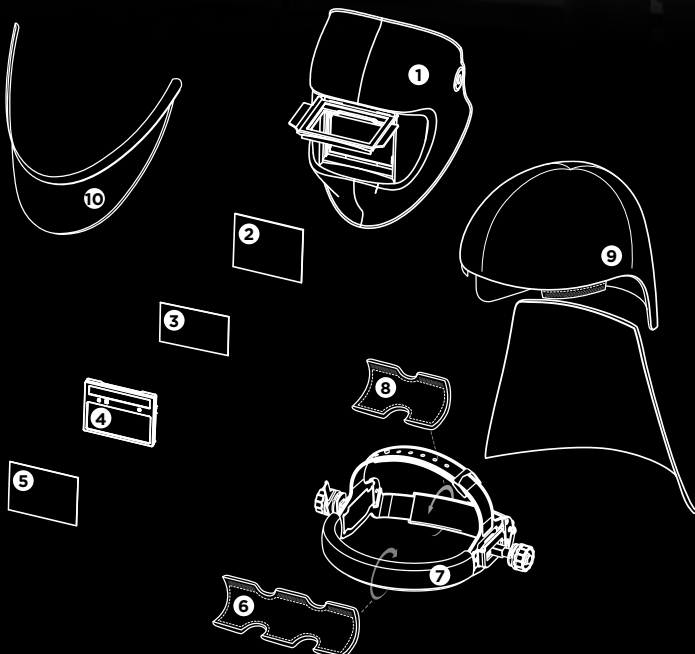

A better view.
Better air.
Better work.



Your optrel Reseller:

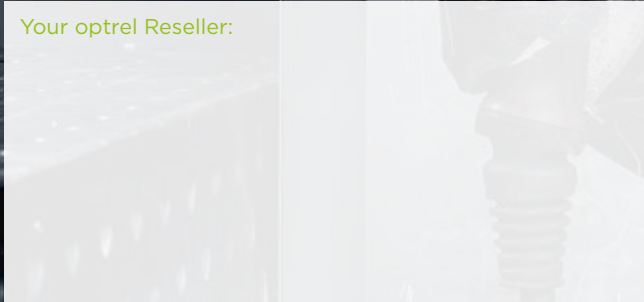

optrel AG
industriestrasse 2
CH-9630 wattwil
switzerland
www.optrel.com
info@optrel.com

optrel.com



Art. no. 9412124.00